



COMMERCIAL INTERIORS

www.gen-eco.com.au





Herbert Smith Freehills Law Firm—Sydney Product: Ecolite American Cherry timber veneer beams

Our Ecolite beams and panels have been installed in many corporate offices across Australia. The Ecolite beams can be applied with many surfaces including creative imagery, natural timber veneer, laminate and paint.

With lightweight Balsa as the core material, Ecolite beams have distinct advantages in installation costs and the ability to create interesting profiles.



Theiss Head Office—Southbank Brisbane Installer : In 2 Joinery Product: Ecolite Walnut imagery



1 King William St, Adelaide Architect: IA Design Joiner: Spry & Spry
Product: 35mm thick Ecolite panels with rustic veneer overlay

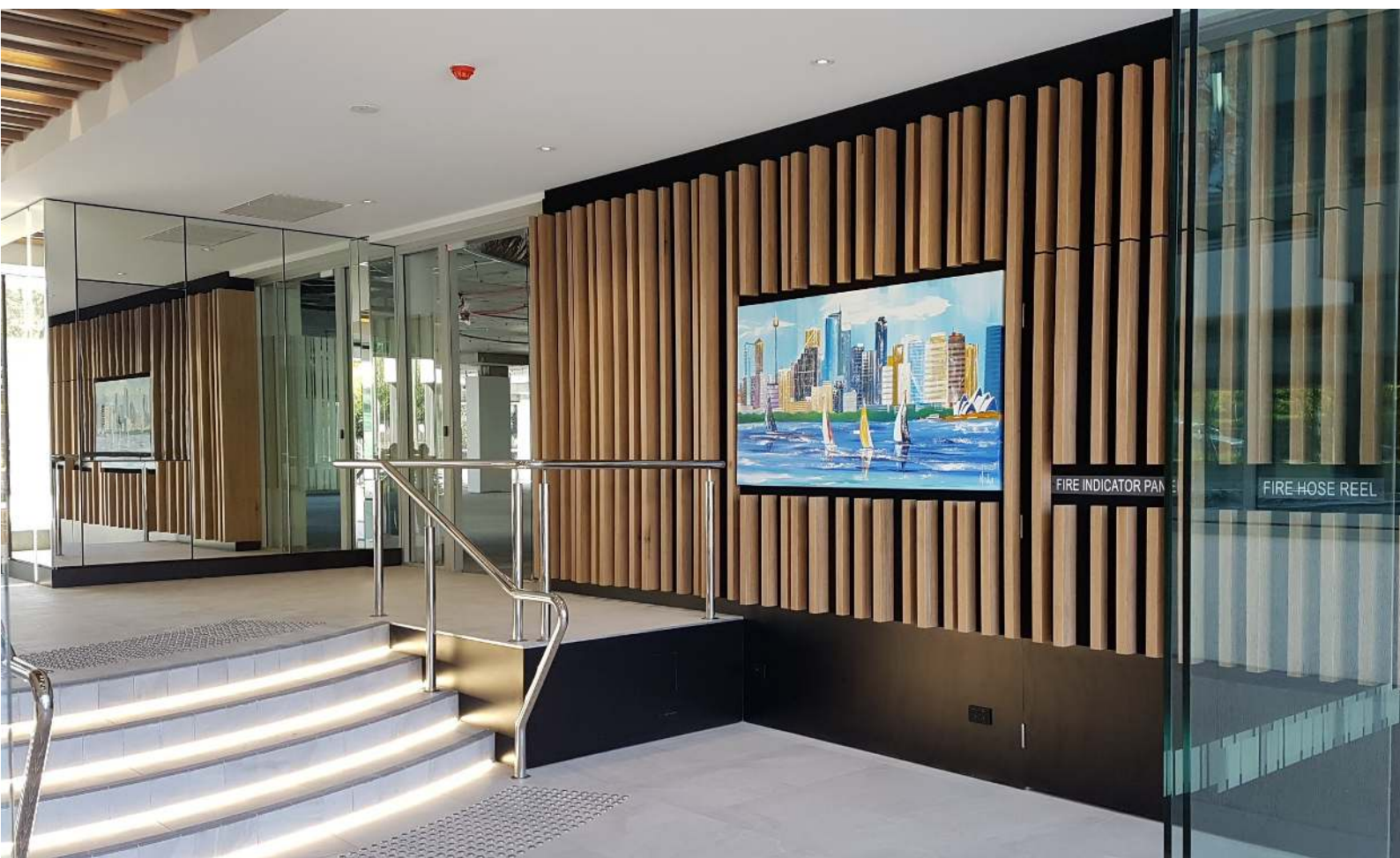

Corporate House—Pymble Place, Sydney Architect: Architects Dovey Installer: Concept Interiors
Product: Ecolite battens with Spotted Gum imagery



Scottish Pacific Offices—Sydney Shopfitter: Woodland Shopfitting
Product: Ecolite beams with Spotted Gum imagery



Camera Pro—Brisbane Designer: Troupe Studio Product: Ecolite beams with Tasmanian Oak imagery